

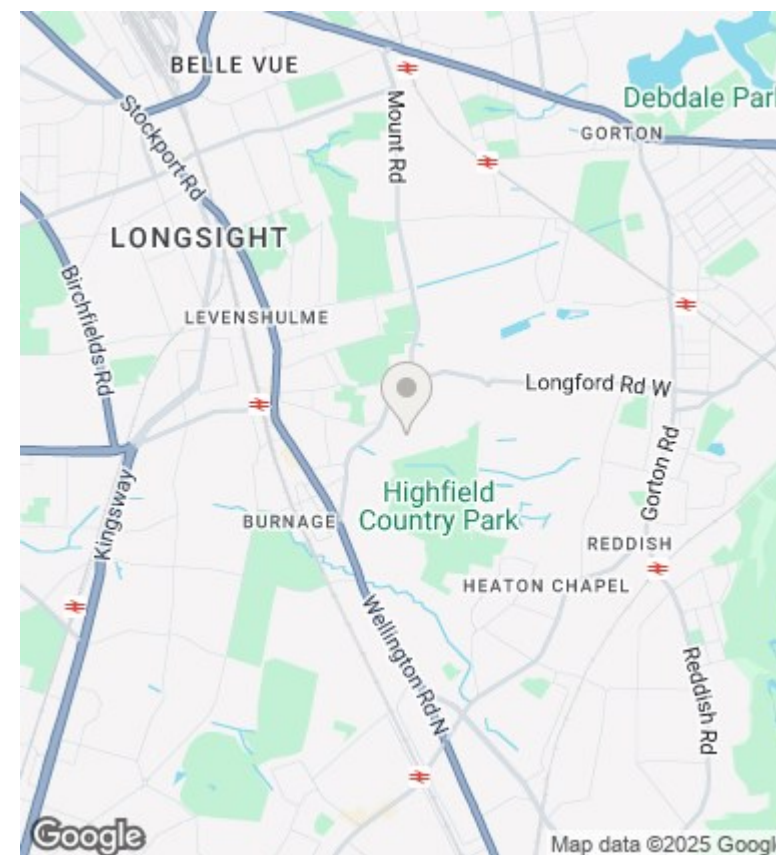

30 Highfield Road, Levenshulme, Manchester, M19 3JX

Offers Over £245,000

- Three bed semi-detached house available for sale
- Well-proportioned bedrooms
- Decent - sized rear garden
- School catchment area
- Spacious Living room
- Modern family bathroom
- Suitable for families, professionals and investors
- Kitchen and diner
- Front Driveway
- Levenshulme Train station is short walk away

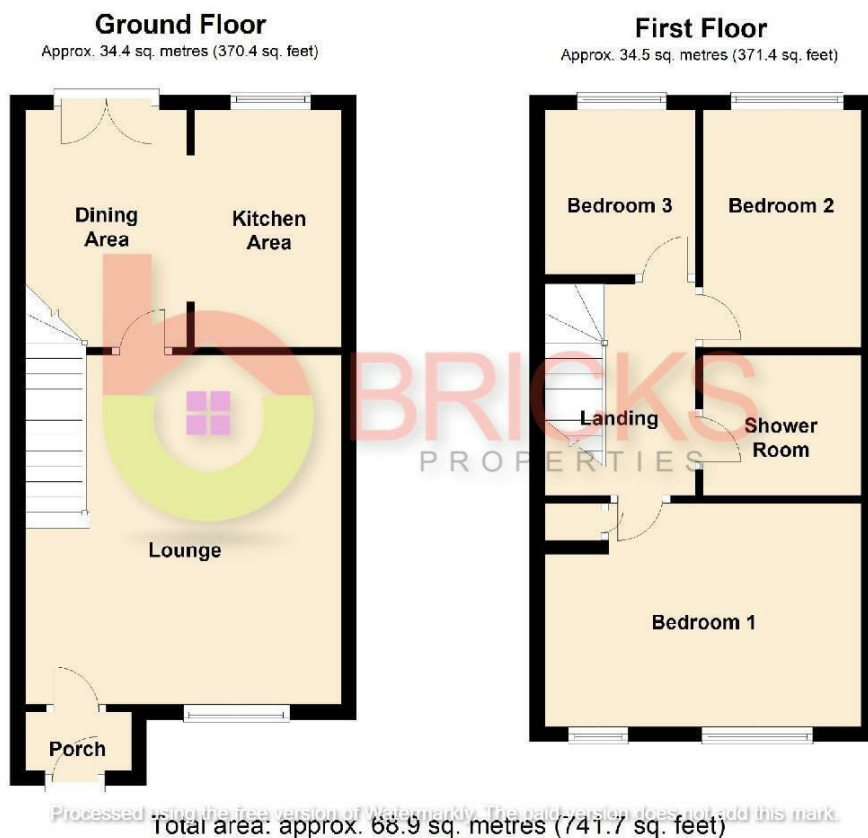

Directions

Viewings

Viewings by arrangement only. Call 0161 804 3480 to make an appointment.

Council Tax Band

EPC Rating:

C

Energy Efficiency Rating		
	Current	Potential
Very energy efficient - lower running costs		
(92 plus) A		
(81-91) B		
(69-80) C		
(55-68) D		
(39-54) E		
(21-38) F		
(1-20) G		
Not energy efficient - higher running costs		
England & Wales EU Directive 2002/91/EC		